



# HO Structure Kit

## MERCHANTS ROW IV

933-4040

Thanks for purchasing this Cornerstone® kit. Please read these instructions and study the drawings before starting construction. All parts of the building are plastic, so use compatible glue and paint to complete your model. Please Note: Interior mounting points are provided for adding scratchbuilt ceilings/floors and interior walls if desired. If you wish to paint your model, brick structures are usually natural "earth" colors, with light or dark mortar between each course of bricks. Many were painted a solid color in later years. Wooden windows and doors were painted various trim colors, while decorative accents on the front wall and roofline (carved wood covered with sheet metal) were often painted to look like stone.

During the late 1800s and well into the 20th century, brick buildings dominated American business districts in cities and towns of all sizes. Built from brick made locally or shipped in by train, it provided strength and fire protection. But as lot sizes were small and space at a premium, commercial buildings made maximum use of the available area by combining several businesses under one roof. Each storefront had its own entrance, and was separated from its neighbors by interior firewalls. The lower level had large display windows that let in natural light and showcased the merchandise. As the upper floors were often rented for apartments or offices, a separate stairway was provided for access and as a fire escape. Typically, only the front of the building was embellished with any decoration, as it was the most visible to the public. Over the years, it was common to remodel the front with a new entrance, windows or a completely new facade as owners sought to project a more up-to-date image. Today, many owners have come to appreciate the historic significance of such structures, restoring them to more closely resemble their as-built appearance. With appropriate signs, figures and vehicles, your new model is perfect for small town or big city scenes from the 1880s to the present. See your local hobby dealer and the latest Walthers HO Reference Book or visit [walthers.com](http://walthers.com) for additional accessories to complete your model.

1) Two optional Cornices (11, 12) are provided for the left front storefront; glue a Cornice in place on Front Wall (2). Note the location of window glazing and glue as shown to raised window frames on the inside of Walls (2, 3, 4, 5). Glue Entry Doors (2x 9, 10) in place on Front Wall (2). Install Display Windows (4x 28 and 2x 26) as shown. When dry, glue Door Glass (2x 29, 30, 36 and 10) in place.

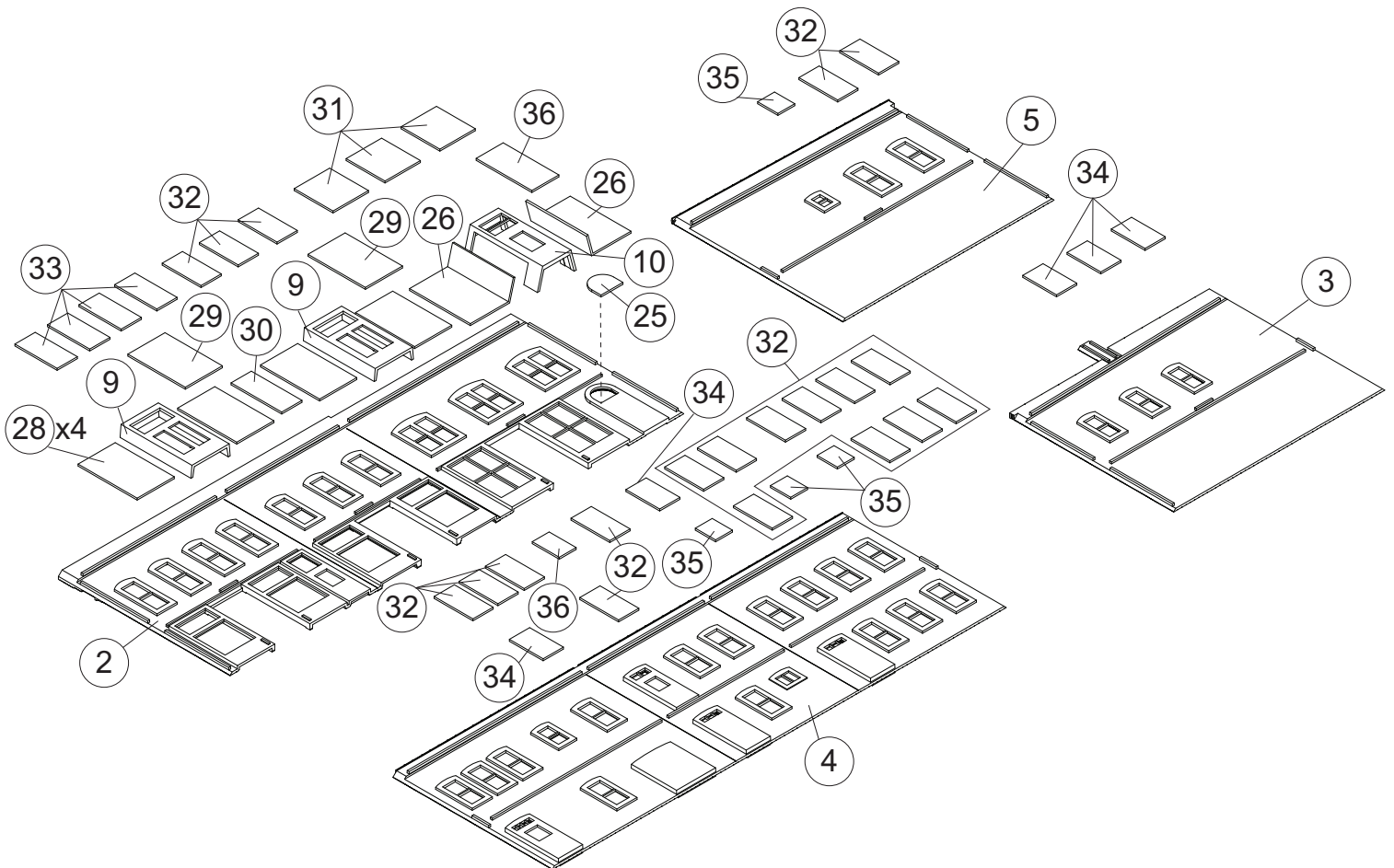

2) Glue Walls (2, 3, 5) to Base (1) as shown. If desired, the printed interiors or optional inside floors/ceilings and walls (not included) may be added at this time: use the raised ridges molded on the inside of each wall as mounting points. If you plan to add lighting or interior details, simply set the floors in place. Glue Rear Wall (4) to Side Walls and Base. Roof (6) may be set in place if you wish to add lights or details (sold separately), or glued in place.

3) Glue Chimney Walls (19, 20, 21) as shown to Right Wall (3) and add Chimney Cap (22) as shown. Assemble two Chimneys, one for each of the remaining stores, from Chimney Walls (4x 18) and Chimney Caps (2x 22). Glue chimney to the flat spots on roof above center store and left store when looking at front of structure. Glue Fire Walls (2x each 7, 8) together, and into slots of the Roof as shown.

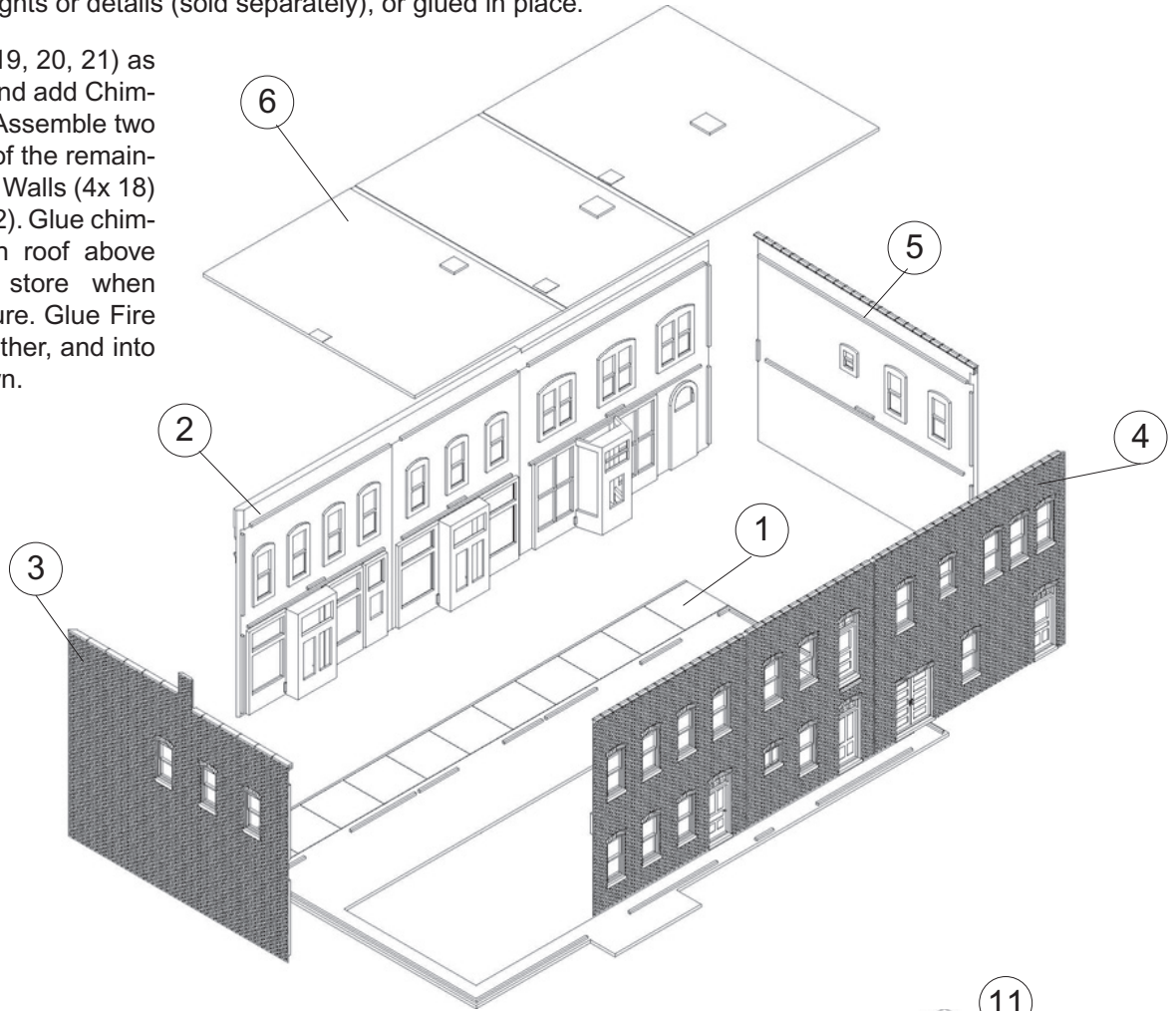

4) Two styles of Scuppers and Downspouts, Single (2x 23) and Double (2x 24) are provided. The Single style can be glued to the back corner of the Rear Wall (4), or at the rear of Side Walls (3, 5). Glue the Double style to the Rear Wall (4), with a scupper on each side of the rooftop Fire Walls.

5) Glue Landing (13) to Brackets (16, 17) as shown. Glue this assembly below the second story doorway as shown. Glue Stairs (14) to Landing. Glue Outside Handrail (15) to Stairs and Landing.

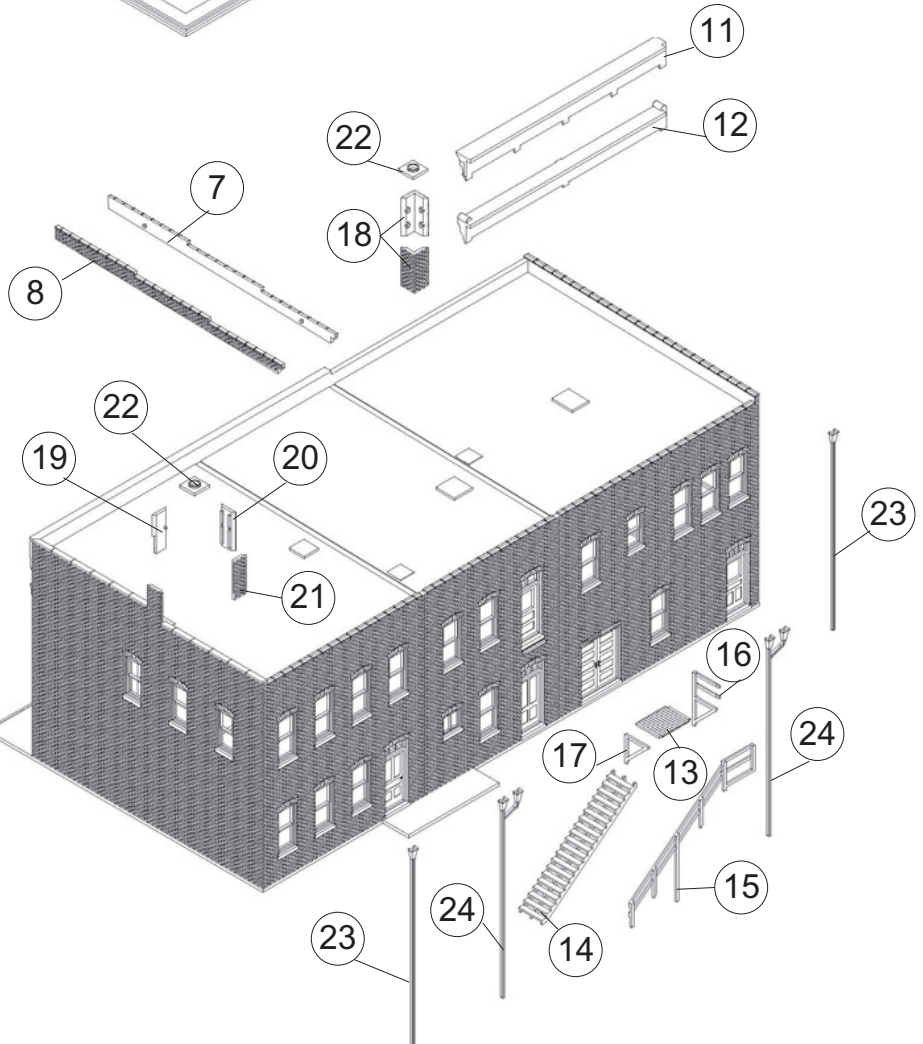

Note: Please read special instruction on decal for special placements.

**DECALING**

1. After cutting out the decal, dip in water for 10 seconds, remove and let stand for 1 minute. Slide decal onto surface, position and then blot off any excess water.
2. Lightly brush Micro Sol® on top. This will soften the decal allowing it to conform to irregular surfaces. DO NOT TOUCH DECAL while wet!
3. When the decal is thoroughly dry, check for any trapped air bubbles. Prick them with the point of a small pin or hobby knife blade and apply more Micro Sol®.